















**Roller tracks and toothed brushes for glass and window construction**



- Material that is sensitive to scratching is especially carefully stored and transported via toothed brushes during manufacturing or assembly.
- Toothed brushes of type GL PA/2000 can be used, for example, for assembly benches in synthetic window construction, or as guide rails for extremely sensitive workpieces.

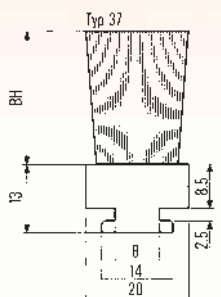

**Toothed brushes**

Ident. No.	Order No.	Body material	Type	Installation height	Length	Number of rows	Edging material
			mm	mm	mm		
0010880	GL PA/2000	PVC green	37	8.0	2000	3	0.20 PA 6 weiß

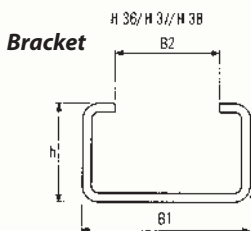

**Profile rail made of galvanized steel**

Ident. No.	Order No.	B1	B2	h	Standard length
		mm	mm	mm	mm
0010255	HG2/2000	18.0	9.0	12.0	2000

**SF-Flex flexible side guide**

For use as a linear guide or in curves with min. 500 mm radius. Available as a single element 348.5 mm long for attaching to steel bar 40 x 8 mm or as a complete track with length of 3000 mm, complete with stainless steel M-profile.

- Especially quiet running
- Simple installation
- Compact construction
- Narrowest roller pitch
- Other designs, dimensions, and colors available on request.

**SF-Flex50**

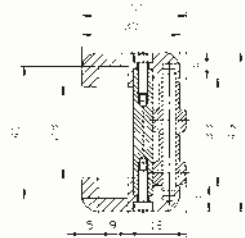

**SF-Flex80**

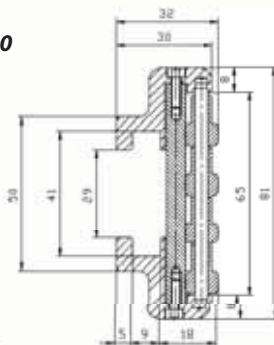

Ident. No.	Order No.		Length	Height
			mm	mm
0034856	SF-Flex50x3000	Complete with VA M-profile	3000	49
0034858	SF-Flex50x350	Single module	348.5	49

Ident. No.	Order No.		Length	Height
			mm	mm
0034857	SF-Flex80x3000	Complete with VA M-profile	3000	81
0034859	SF-Flex80x350	Single module	348.5	81

Leaving technical changes!



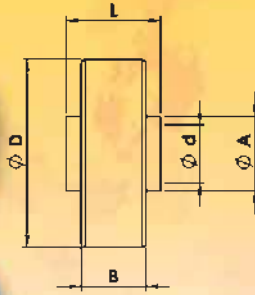

## Conveyor rollers

- Torwegge conveyor rollers are available in steel, plastic, and steel with rubber tire versions.
- **They are primarily used in wheel conveyors, and roller tracks for flow storage systems.**
- The new deep groove ball bearings ensure that the Torwegge conveyor rollers run smoothly and evenly.
- **The steel sheet parts and hubs are galvanized for corrosion protection.**
- The cones, balls, and ball race are hardened and lightly oiled (rollers with POM balls are not oiled). The use of POM balls in the rollers ensures low running noise.

Ident. No.	Order No.	D mm	d mm	A mm	L mm	B mm	Material	Bearing	Color	Load-carrying capacity daN (kp)
0011525	2200/28	28	6	11	24	12	Steel, galvanized	Ball bearing	galvanized	10
0011527	2200/48	48	6	12	24	16	Steel, galvanized	Ball bearing	galvanized	20
0011528	2200/48/8	48	8	12	24	16	Steel, galvanized	Ball bearing	galvanized	20
0027508	2200/48POM	48	6	12	24	16	Steel, galvanized	POM balls	galvanized	15
0027509	2200/48/8POM	48	8	12	24	16	Steel, galvanized	POM balls	galvanized	15
0011529	2200/50/8	50	8	13	68	63	Steel, galvanized	Ball bearing	galvanized	40
0011523	2200/100/6	100	6	11	24	16/1.8	Steel, galvanized	Ball bearing	galvanized	20
0011524	2200/100/8	100	8	13	24	16/1.8	Steel, galvanized	Ball bearing	galvanized	20
0011531	2300/48	48	6	12	24	16	Plastic	Ball bearing	blue	10
0011532	2300/48/8	48	8	12	24	16	Plastic	Ball bearing	blue	10
0011533	2300/48/Niro	48	6	12	24	16	Plastic	Stainless steel balls	blue	10
0016659	GL/050/8/21.5	50	8	16	22	18	Polyamide	Plain bearing	black	40
0011536	2300/54/8-GU	54	8	12	24	19	Rubber	Ball bearing	Blue-gray	15
0011543	2400/48/8-Gelb	48	8	17.4	23.5	17	Plastic/PU	Plain bearing	yellow	40
0028452	2400/48/8K-Gelb	48	8	14.4	23.5	17	Plastic/PU	Ball bearing	yellow	40
0011534	2300/50/8-BÜRSTE HART	50	8	-	23	20	Plastic/PA	Plain bearing	Black-gray	2
0022369	NR40	54	8	12	51	48	Steel plastic coated	Ball bearing	blue	40
0017225	NR50	54	8	18	52	48	Polyamide	Ball bearing	white	150
0016651	NR70	54	8	15	50.5	48	Plastic	Plain bearing	black	60
0026926	NR80	50	8	16	52	48	Steel, galvanized	Ball bearing	galvanized	160
0022349	NR100/50/8	50	8.2	16	74	68	Steel, galvanized	Ball bearing	galvanized	160
0022792	NR110/50/8PVC2mm	54	8.2	16	74	68	Steel galv./soft PVC	Ball bearing	silver	120
0022360	NR200/60/10	60	10	18	124	118	Steel, galvanized	Ball bearing	galvanized	160
0024322	NR210/60/10	64	10	18	124	118	Steel galv./soft PVC	Ball bearing	silver	160

\* With cast-on rubber tire

\*\* With polyurethane coating and POM-GL bushing



## Multi-directional wheels

- TORWEGGE- multi-directional wheels can be used wherever there are large-surface units, goods containers, packages, boxes, or workpieces to be rotated, sorted, diverted, fed, or picked.

- **Torwegge multi-directional wheel tracks can be used to create large table surfaces of any size.**
- These wheels, however, should only be used for light loads.
- **Please conduct trial runs in advance!**

Ident. No.	Order No.	D mm	d mm	A mm	L mm	B mm	Material	Bearing	Color	Load-carrying capacity daN (kp)
0014873	AR 10	50	8.2	14	19	-	Plastic	Plain bearing	white/black	5
0014957	ASR 50	50	8.2	14	40	28	Plastic	Plain bearing	white/black	10
0014958	ASR 60	60	8.2	20	53	31	Plastic	Plain bearing	white/black	20
0014959	ASR 60-Soft	60	8.2	20	53	31	Plastic	Plain bearing	white/black	20
0014960	ASR 80	80	8.2	35	60	45	Plastic	Plain bearing	white/black	40

## Multi-directional wheels, sturdy construction

- The center of the wheel rotates around a principal axle.
- The roller wheel is equipped with ribs.
- Six barrel rollers are located between the ribs.
- These barrel rollers operate transversely to the main direction of travel, which means that an item can be transported in all directions.
- All wheel parts are manufactured from plastic polyamide PA6.6; the axles are made of V2A.



Ident. No.	Order No.	Multi-directional wheels	Installation width	Axle/Thread	Axle length	Material	Bearing	Load-carrying capacity daN (kp)
		Ø						
mm	mm	mm	mm	mm	mm			
0015025	AWR40	40	31	8	-	Polyamide red	Plain bearing	10
0015027	AWR40 PUR	40	31	8	-	Polyurethane green	Plain bearing	10
0015026	AWR40 Achse	40	31	8/M6	50	Steel, galvanized	Plain bearing	10
0015028	AWR48	48	41	8	-	Polyamide gray	Plain bearing	15
0015029	AWR48 Achse	48	41	8/M6	58	Steel, galvanized	Plain bearing	15
0015030	AWR60	60	50	8	-	Polyamide gray	Plain bearing	20
0015032	AWR60 PUR	60	50	8	-	Polyurethane green	Plain bearing	20
0015031	AWR60 Achse	60	50	8/M6	71	Steel, galvanized	Plain bearing	20
0034751	AWR80	80	66	8	-	Polyamide black	Plain bearing	40
0034752	AWR80 PUR	80	66	8	-	Polyurethane aubergine	Plain bearing	40
0034753	AWR80 ALU	80	66	8	-	Aluminum	Plain bearing	40
0015034	AWR80 Achse	80	66	8/M6	88	Steel, galvanized	Plain bearing	40
0015023	AWR120	120	93	12	-	Polyamide gray	Plain bearing	60
0026925	AWR120 PUR	120	93	12	-	Polyurethane green	Plain bearing	60
0015024	AWR120 Achse	120	93	12/M10	129	Steel, galvanized	Plain bearing	60

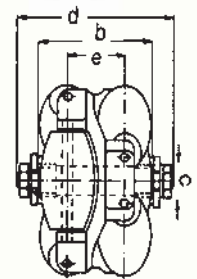

## Flanged rollers

Ident. No.	Order No.	D	S	d	B	L	Material	Bearing	Load-carrying capacity
									daN (kp)
mm	mm	mm	mm	mm	mm	mm			
0011549	2450/8	50	66	8	21	18	Steel, galvanized	Ball bearing	15
0011550	2460/6	50	76	6	31	24	Steel, galvanized	Ball bearing	10
0011551	2460/8	50	76	8	31	24	Steel, galvanized	Ball bearing	15
0011552	2470/M8x18	50	76	-	46	40	Steel, galvanized	Ball bearing	40
0023985	SR100/50/8	50	72	8	74	68	Steel, galvanized	Ball bearing	160
0011539	2350/6Ku	48	66	6	16.5	19.5	Plastic	Ball bearing	10
0011541	2350/8Ku	48	66	8	16.5	19.5	Plastic	Ball bearing	10
0011540	2350/6Ku/Niro	48	66	6	16.5	19.5	Plastic	Stainless steel bearing	10
0011542	2350/8Ku/Niro	48	66	8	16.5	19.5	Plastic	Stainless steel bearing	10
0023991	SR40	54	70	8	48	44	Steel plastic coated	Ball bearing	40
0026927	SR80	50	72	8.2	48	44	Steel, galvanized	Ball bearing	160

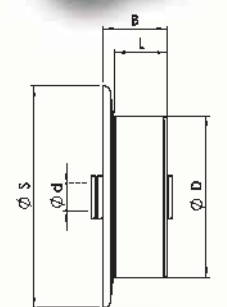

## Polypropylene rollers

Order No. 2410 and 2412/stainless steel with flange  
Order No. 2411 and 2413/stainless steel without flange

Ident. No.	Order No.	D	S	B	L	Material	Bearing	Load-carrying capacity
								daN (kp)
mm	mm	mm	mm	mm	mm			
0011544	2410M8x15	38	60	28	25	Plastic	2 ball bearings	10
0011545	2411M8x15	38	-	28	28	Plastic	2 ball bearings	10
0011546	2412/NiroM8x18	38	60	28	25	Plastic	2 ball bearings	8
0011547	2413/NiroM8x18	38	-	28	28	Plastic	2 ball bearings	8

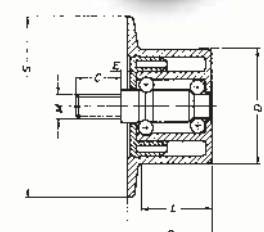

## Lightweight slewing rings

Lightweight plastic slewing rings for rotating stands and rotary tables in the furniture industry.

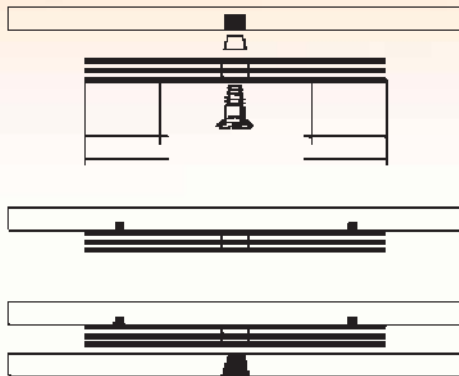
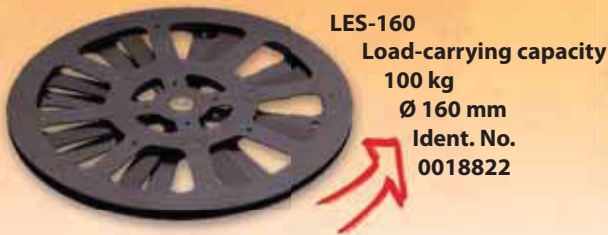

### Various attachment options

A 10-mm hole is made in the center of the plate (underside). Insert nylon bushing (diameter 11 x 6 MA) into the hole in the plate, center, insert screw, and tighten.

Center the slewing ring on the plate. Tighten the screws in the holes of the washers resting on the plate (underside).

Make a slightly countersunk hole for the screw M8 in the center of the base plate. Place both plates on top of each other, insert the screw M8, and tighten.

## Design of ball steering rings

Metal and plastic ball steering rings are the ideal solution for aligning pallets. They consist of two concentric rings made of metal or plastic. The rotation of the two rings occurs through numerous steel balls, which guarantee the highest gliding ability. The rotating mechanisms allow the rotation of the outer ring when it is lying on one side; if it lies on the other side, the inner ring rotates. The rings are each

equipped with rubber suction cups to prevent slipping. They can be attached on both sides and to inclined surfaces. The racks on the inner rings of some units enable automation.



**LE 320-10 (Ident. No. 0018813)**

Ball steering ring made of metal, Ø 320 mm (outer plate), load-carrying capacity 300 kg, thickness 13.4 mm without plate, 16 mm with plate, color black.



**LE 280-10 (Ident. No. 0018811)**

Ball steering ring made of plastic, Ø 280 mm (outer plate), load-carrying capacity 200 kg, thickness 13 mm without plate, 18 mm with plate, color black.



**LE 230-10 (Ident. No. 0018809)**

Ball steering ring made of plastic, Ø 230 mm (outer plate), load-carrying capacity 200 kg, thickness 13 mm without plate, 18 mm with plate, color black.



**LE 320-20 (Ident. No. 0018814)**

as above, but in gray.



**LE 280-30 (Ident. No. 0018812)**

As above, but with transparent color, especially suited for glass and window panes.



**LE 230-30 (Ident. No. 0018810)**

As above, but with transparent color, especially suited for glass and window panes.