

# 104 Stirnräder

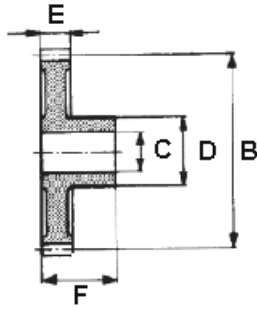
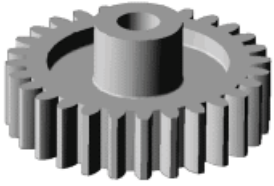

Aus 100 % Polyacetal-Kunststoff (POM) für eine geräuscharme und stoßfreie Übertragung. Gebrauchstemperatur bis 95 °C. Maximale Zahnfußbelastung von 35 N/mm<sup>2</sup>. Toleranzen: 140 DIN 16901. Eingriffswinkel: 20°. X = Zähnezahl.

Material: POM

Farbe: natur



## Modul 0,5

Article	X	B	C	D	E	F
		mm	mm	mm	mm	mm
104 0027	15,0	7,5	3,0	6,0	3,0	10,0
104 0028	18,0	9,0	4,0	8,0	3,0	10,0
104 0029	20,0	10,0	4,0	8,0	3,0	10,0
104 0030	25,0	12,5	4,0	10,0	3,0	10,0
104 0031	30,0	15,0	4,0	12,0	3,0	10,0
104 0032	35,0	17,5	4,0	12,0	3,0	10,0
104 0033	40,0	20,0	4,0	12,0	3,0	10,0

Article	X	B	C	D	E	F
		mm	mm	mm	mm	mm
104 0034	45,0	22,5	4,0	12,0	3,0	10,0
104 0035	48,0	24,0	6,0	15,0	3,0	10,0
104 0036	50,0	25,0	6,0	15,0	3,0	10,0
104 0037	60,0	30,0	6,0	15,0	3,0	10,0
104 0038	72,0	36,0	6,0	15,0	3,0	10,0
104 0039	96,0	48,0	6,0	15,0	3,0	10,0
104 0040	120,0	60,0	6,0	15,0	3,0	10,0

## Modul 1

Article	X	B	C	D	E	F
		mm	mm	mm	mm	mm
104 0001	12,0	12,0	4,0	9,0	8,0	16,0
104 0002	15,0	15,0	4,0	9,0	8,0	16,0
104 0003	18,0	18,0	4,0	9,0	8,0	16,0
104 0004	20,0	20,0	6,0	12,0	8,0	16,0
104 0005	21,0	21,0	6,0	12,0	8,0	16,0
104 0006	24,0	24,0	6,0	12,0	8,0	16,0
104 0007	28,0	28,0	6,0	12,0	8,0	16,0

Article	X	B	C	D	E	F
		mm	mm	mm	mm	mm
104 0008	30,0	30,0	6,0	12,0	8,0	16,0
104 0009	32,0	32,0	6,0	12,0	8,0	16,0
104 0010	35,0	35,0	8,0	16,0	8,0	20,0
104 0011	40,0	40,0	8,0	16,0	8,0	20,0
104 0012	45,0	45,0	8,0	16,0	8,0	20,0
104 0013	50,0	50,0	8,0	16,0	8,0	20,0
104 0014	60,0	60,0	8,0	16,0	8,0	20,0

## Modul 1,5

Article	X	B	C	D	E	F
		mm	mm	mm	mm	mm
104 0041	12,0	18,0	6,0	14,0	12,0	23,0
104 0042	15,0	22,5	6,0	14,0	12,0	23,0
104 0043	18,0	27,0	8,0	17,0	12,0	23,0
104 0044	20,0	30,0	8,0	17,0	12,0	23,0
104 0045	24,0	36,0	8,0	18,0	12,0	23,0

Article	X	B	C	D	E	F
		mm	mm	mm	mm	mm
104 0046	25,0	37,5	8,0	18,0	12,0	23,0
104 0047	30,0	45,0	10,0	24,0	12,0	23,0
104 0048	35,0	52,5	10,0	24,0	12,0	23,0
104 0049	40,0	60,0	10,0	24,0	12,0	23,0

## Modul 2

Article	X	B	C	D	E	F
		mm	mm	mm	mm	mm
104 0015	12,0	24,0	8,0	18,0	15,0	25,0
104 0016	15,0	30,0	8,0	18,0	15,0	25,0
104 0017	18,0	36,0	8,0	18,0	15,0	25,0
104 0018	20,0	40,0	10,0	20,0	15,0	25,0
104 0019	21,0	42,0	10,0	20,0	15,0	25,0
104 0020	24,0	48,0	10,0	20,0	15,0	25,0

Article	X	B	C	D	E	F
		mm	mm	mm	mm	mm
104 0021	25,0	50,0	10,0	20,0	15,0	25,0
104 0022	28,0	56,0	10,0	20,0	15,0	25,0
104 0023	30,0	60,0	10,0	20,0	15,0	25,0
104 0024	32,0	64,0	12,0	24,0	15,0	30,0
104 0025	35,0	70,0	12,0	24,0	15,0	30,0
104 0026	40,0	80,0	12,0	24,0	15,0	30,0